

Visit our website at
www.oakcreekwi.org
for the agenda and
accompanying
common council
reports.



Common Council
Chambers
8640 S. Howell Ave.
PO Box 27
Oak Creek, WI 53154
(414) 768-6500

COMMON COUNCIL MEETING AGENDA

TUESDAY, JANUARY 21, 2014
AT 7:00 P.M.

COUNCIL MEETINGS CAN BE SEEN LIVE ON GOVERNMENT ACCESS CHANNELS 25 AND 99

1. Call Meeting to Order / Roll Call
2. Pledge of Allegiance
3. Approval of Minutes: 1/7/14

Public Hearings (beginning at 7:00 p.m.)

Citizen input, comments and suggestions are requested on the specific item(s) identified below. Action by the Council may occur at the same meeting if so included in the agenda.

4. **Conditional Use:** Consider a conditional use permit application by Dave DeVries, SET Environmental, Inc., for an environmental contractor's yard with outdoor storage located at 9730 S. 20th St. (6th District).
5. **Ordinance:** Consider Ordinance No. 2705, approving a conditional use permit for an environmental contractor's yard with outdoor storage located at 9730 S. 20th St. (6th District).

Presentations

6. **Presentation:** Presentation by Bray Architects; Owner's Representative, Steve Chamberlin; and Community Development Director, Douglas Seymour, to update the Council on the City Hall, Library and Fire Station project.
7. **Resolution:** Consider Resolution No. 11451-012114, a Resolution of Appreciation to Sandra K. DeFord, retiring Administrative Support Assistant (by Committee of the Whole).

New Business

MAYOR & COMMON COUNCIL

8. **Motion:** Consider a motion to approve the license agreement with SESAC (Society of European Stage Authors and Composers), BMI (Broadcast Music Inc.), and ASCAP for the re-broadcast of music by licensed performers (by Committee of the Whole).
9. **Motion:** Consider a motion to approve the 2013 Vendor Summary Report in the amount of \$391,575.24 and 2014 Vendor Summary Report in the amount of \$316,471.34, for a total of all claims of \$708,046.58 (by Committee of the Whole).

LIBRARY

10. **Resolution:** Consider *Resolution* No. 11450-012114, acknowledging and filing the 2014 calendar year salary grade plan and benefits for library personnel (by Committee of the Whole).

FIRE

11. **Motion:** Consider a *motion* to approve the purchase of one Stryker Power-Pro XT cot from Stryker Medical in the amount of \$15,518 (by Committee of the Whole).

LICENSE COMMITTEE

The License Committee did not meet prior to the 1/21/14 meeting. Tentative recommendations are being made as follows:

12. **Motion:** Consider a *motion* to grant an Operator's license to the following (*favorable background report received*):
- Travis Hayden, 65 E. Field Stone Cir., Oak Creek (Noodles & Co.).
13. **Motion:** Consider a *motion* to grant a 2014 Dog Kennel license to the following (department approvals received):
- Bradley Osgood, Brentwood Animal Hospital, 318 W. Ryan Rd.
 - Sue Ann McCotter, Club K-9 LLC dba Central Bark Doggy Day Care, 1075b W. Northbranch Dr.
14. **Motion:** Consider a *motion* to grant a 2014 Mobile Home Park license to the following:
- Oak Creek Estates, LLC dba Oak Creek Estates, 2137-2301 W. College Ave.
 - Fifth Avenue Development Group, LLC dba Sunrise Shores Mobile Home Park, 8481 S. Fifth Ave.

MISCELLANEOUS

15. **Motion:** Consider a *motion* to convene in to Closed Session immediately following the conclusion of the Common Council meeting pursuant to Wisconsin State Statutes Section 19.85 (1)(g) to discuss potential litigation against Thomas W. and Karen M. Jungck regarding the installation of the final lift of asphalt and other improvements in the Emerald Meadows Addition #2 Subdivision.
16. **Motion:** Consider a *motion* to reconvene into Open Session.
17. **Motion:** Consider a *motion* to take action, if required.

Adjournment.

Public Notice

Upon reasonable notice, a good faith effort will be made to accommodate the needs of disabled individuals through sign language interpreters or other auxiliary aid at no cost to the individual to participate in public meetings. Due to the difficulty in finding interpreters, requests should be made as far in advance as possible preferably a minimum of 48 hours. For additional information or to request this service, contact the Oak Creek City Clerk at 768-6511, (FAX) 768-9587, (TDD) 768-6513 or by writing to the ADA Coordinator at the Health Department, City Hall, 8640 S. Howell Avenue, Oak Creek, Wisconsin 53154.

It is possible that members of and possibly a quorum of members of other governmental bodies of the municipality may be in attendance at the above-stated meeting to gather information; no action will be taken by any governmental body at the above-stated meeting other than the governmental body specifically referred to above in this notice

OFFICIAL NOTICE

**NOTICE OF PUBLIC HEARING
BEFORE THE OAK CREEK COMMON COUNCIL**

PURPOSE: The purpose of this public hearing is to consider a conditional use permit application by Dave DeVries, SET Environmental, Inc. for an environmental contractor's yard with outdoor storage located 9730 S. 20th St.

Hearing Date: Tuesday, January 21, 2014
Time: 7:00 p.m.
Place: Oak Creek City Hall
8640 South Howell Avenue
Oak Creek, WI 53154
Common Council Chambers

Applicant: Dave DeVries, SET Environmental, Inc.
Property Owner: Jose L. Ibarra & Blanca Ibarra
Property Location: 9730 S. 20th St.
Tax Key(s): 903-0015

Legal Description:

Lot 1, Block 6, Southbranch Industrial Park, being a part of the Northwest ¼, Northeast ¼ and Southeast ¼ of Section 30, in Township 5 North, Range 22 East, in the City of Oak Creek, County of Milwaukee, State of Wisconsin.

The Common Council has scheduled other public hearings for January 21, 2014 at 7:00 PM. This hearing may begin at 7:00 PM or as soon as possible following the conclusion of other public hearings.

Any person(s) with questions regarding the proposed change may call the Department of Community Development at (414) 768-6527, during regular business hours.

Date of Notice: December 26, 2013
CITY OF OAK CREEK COMMON COUNCIL
By: Steve Scaffidi, Mayor

PUBLIC NOTICE

PLEASE NOTE: Upon reasonable notice, a good faith effort will be made to accommodate the needs of disabled individuals through sign language interpreters or other auxiliary aid at no cost to the individual to participate in public meetings. Due to the difficulty in finding interpreters, requests should be made as far in advance as possible, preferable a minimum of 48 hours. For additional information or to request this service, contact the Oak Creek City Clerk at 768-6511, (FAX) 768-9587, (TDD) 768-6513 or by writing to the ADA Coordinator at the Health Department, City Hall, 8640 South Howell Avenue, Oak Creek, Wisconsin 53154.

City of Oak Creek Common Council Report

Meeting Date: January 21, 2014

Item No.: 5

Recommendation: That the Council adopts Ordinance No. 2705, approving a conditional use permit for an environmental contractor's yard with outdoor storage located at 9730 S. 20th St.

Background: At the December 10, 2013 meeting the Plan Commission recommended Common Council approval of a conditional use permit that would allow an environmental contractor's yard with outdoor storage located at 9730 S. 20th St. At the January 14, 2014 Plan Commission meeting, the Commission recommended adoption of the conditions and restrictions as part of the conditional use permit after a public hearing.

Environmental abatement, remediation, measurement, and control work is conducted at specific job sites. All equipment and vehicles used for SET Environmental's operations will be stored at 9730 S. 20th St. No laboratory or testing facilities are proposed as part of this request. Approximately 8 employees are anticipated initially, with 15 anticipated within one year of operation. No new building or sign plans have been submitted at this time.

There is the potential for waste material to be stored within van trailers, tankers, or roll-off boxes on the property until it can be disposed of properly. Per federal regulations, this material cannot be stored onsite for more than 10 days. No waste materials will be transferred onsite.

Currently the property is partially paved (up to the eastern corner of the building); however, a majority of the area proposed for parking of vehicles and storage of equipment is gravel. All areas to be used for vehicle access, movement, and parking as well as storage of equipment must be paved in accordance with the Engineering Design Manual and Municipal Code. No stormwater management plans are required at this time. A paving plan was submitted and approved by the Plan Commission at the January 14, 2014 meeting and is included with this report.

Fiscal Impact: The issuance of this conditional use permit will allow for the use of an existing commercial building.

Prepared by:

Doug Seymour, AICP
Director of Community Development

Respectfully Submitted,

Gerald Peterson, ICMA-CM
City Administrator

Fiscal Review by:

Bridget M. Souffrant
Finance Director / Comptroller

ORDINANCE NO. 2705

By: _____

AN ORDINANCE TO APPROVE A CONDITIONAL USE PERMIT FOR THE PROPERTY
AT 9730 S. 20th ST. FOR AN ENVIRONMENTAL CONTRACTOR'S YARD WITH
OUTDOOR STORAGE

(6th Aldermanic District)

WHEREAS, Dave DeVries, SET Environmental, Inc., has applied for a Conditional Use Permit that would allow for an environmental contractor's yard with outdoor storage located at 9730 S. 20th St.; and

WHEREAS, this property is more precisely described as follows:

COM 109.07 FT S 0D53'30" W OF NW COR OF NW1/4 SEC. 21-5-22 TH S 89D06'30" E 60 FT S 54D06'30" E 279.94 FT S 35D53' 30" W 227.06 FT N 89D06'30" W 82.72 FT TO ELY LI OF AVE N 0D53'30" E 92.61 FT N 54D06'30" W 18.31 FT N 89D06'30" W 60 FT TO W1/4 SEC LI TH N 244 FT TO BEG. EXC MOST WLY PART FOR AVE. CONT.0.960A.

WHEREAS, the Plan Commission reviewed the request and recommended that the Conditional Use Permit be approved; and

WHEREAS, the Common Council held a public hearing on said request on January 21, 2014, at which time all interested parties appeared and were heard; and

WHEREAS, the Plan Commission had recommended that the application for a Conditional Use Permit be approved and authorized subject, however, to the imposition of certain conditions and restrictions upon the construction, location and operation of this Conditional Use and which conditions and restrictions are incorporated by reference into the Conditional Use Permit; and

WHEREAS, following said public hearing and upon recommendation of approval of the Plan Commission, the Common Council is of the opinion that the best interests of the City would be served if the Conditional Use Permit was approved and authorized for the lands hereinabove described, subject, however, to the imposition of certain conditions and restrictions on the design, construction, location and operation of the Conditional Use.

NOW, THEREFORE, the Common Council of the City of Oak Creek does hereby ordain as follows:

SECTION 1: To promote the general welfare, public safety and general planning within the City of Oak Creek, the Building Commissioner is hereby authorized to grant a Conditional Use Permit for an environmental contractor's yard with outdoor storage located at 9730 S. 20th St., which shall include the aforementioned conditions and restrictions.

SECTION 2: The Conditional Use is subject to the aforementioned conditions and restrictions on the design, location, construction and operation of the Conditional Use for the environmental contractor's yard with outdoor storage.

SECTION 3: All ordinances or parts of ordinances and Zoning District Maps made a part of Chapter 17 of the Municipal Code of the City of Oak Creek in conflict herewith are hereby repealed.

SECTION 4: The several sections of this ordinance are declared to be severable. If any section shall be declared, by a decision of a court of competent jurisdiction, to be invalid, such decision shall not affect the validity of other provisions of this ordinance.

SECTION 5: This ordinance shall take effect and be in force from and after its passage and publication.

Passed and adopted this ___ day of _____, 2014

President, Common Council

Approved this ___ day of _____, 2014

Mayor

ATTEST:

City Clerk

VOTE: Ayes _____ Noes _____

City of Oak Creek – Conditional Use Permit
Conditions and Restrictions

Applicant: Dave, DeVries, SET Environmental, Inc. Approved by Plan Commission: 1/14/2014
Property Address: 9730 S. 20th St. Approved by Common Council: 2/4/2014
Tax Key Number: 903-0015 (Ord. #2705)
Conditional Use: Environmental Contractor's Yard with outdoor storage.

1. LEGAL DESCRIPTION

Lot 1, Block 6, Southbranch Industrial Park, being a part of the Northwest ¼, Northeast ¼ and Southeast ¼ of Section 30, in Township 5 North, Range 22 East, in the City of Oak Creek, County of Milwaukee, State of Wisconsin.

2. REQUIRED PLANS, EASEMENTS, AGREEMENTS AND PUBLIC IMPROVEMENTS

A. A precise detailed site plan for the area affected by the conditional use shall be submitted to, and approved by, the Plan Commission prior to the issuance of any building or occupancy permits. This plan shall show and describe the following:

1) **General Development Plan**

- a) detailed building locations with setbacks
- b) square footage of building
- c) areas for future expansion
- d) area to be paved
- e) access drives (width and location)
- f) sidewalk locations
- g) parking layout and traffic circulation
 - i) location
 - ii) number of employees
 - iii) number of spaces
 - iv) dimensions
 - v) setbacks
- h) location of loading berths
- i) location of sanitary sewer (existing and proposed)
- j) location of water (existing and proposed)
- k) location of storm sewer (existing and proposed)
 - i) including detention/retention basins if needed
- l) precise location of outdoor storage
- m) location of wetlands (field verified)
- n) location, square footage and height of signs
- o) a description of the vehicles, materials and equipment to be stored at the site

2) **Landscape Plan**

- a) screening plan for outdoor storage

- b) number, initial size and type of plantings
- c) parking lot screening/berming

3) **Building Plan**

- a) architectural elevations
- b) building floor plans
- c) materials of construction

4) **Lighting Plan**

- a) types of fixtures
- b) mounting heights
- c) type of poles
- d) photometrics of proposed fixtures

5) **Grading, Drainage and Stormwater Management Plan**

- a) contours (existing and proposed)
- b) location of storm sewer (existing and proposed)
- c) location of stormwater management structures and basins (if required)

6) **Fire Protection**

- a) location of existing and proposed fire hydrants (public and private)
- b) interior floor plan
- c) materials of construction

B. All plans for new buildings, additions, or exterior remodeling shall be submitted to the Plan Commission for their review and approval prior to the issuance of a building permit.

C. For any new buildings or structures and additions, site grading and drainage, stormwater management and erosion control plans shall be submitted to the City Engineer for approval, if required. The City Engineer's approval must be received prior to the issuance of any building

permits.

- D. Plans and specifications for any necessary public improvements within developed areas (e.g. sanitary sewer, water main, storm sewer, etc.) shall be subject to approval by the City Engineer.
- E. If required by the City of Oak Creek, public easements for telephone, electric power, sanitary sewer, storm sewer and water main shall be granted. Said easements shall be maintained free and clear of any buildings, structures, trees or accessory outdoor appurtenances. Shrubbery type plantings shall be permitted; provided there is access to each of the aforementioned systems and their appurtenances.
- F. All new electric, telephone and cable TV service wires or cable shall be installed underground within the boundaries of this property.
- G. For each stage of development, detailed landscaping plans showing location, types and initial plant sizes of all evergreens, deciduous trees and shrubs, and other landscape features such as statuary, art forms, water fountains, retaining walls, etc., shall be submitted to the Plan Commission for approval prior to the issuance of a building permit.

3. PARKING AND ACCESS

- A. **Parking requirements for this project shall be provided in accordance with Section 17.0403 of the Municipal Code and the plans approved by the Plan Commission on January 14, 2014.**
- B. Where 90° parking is indicated on the site plans, individual-parking stalls shall be nine (9) feet in width by eighteen (18) feet in length. The standards for other types of angle parking shall be those as set forth in Section 17.0403(d) of the Municipal Code.
- C. Movement aisles for 90° parking shall be at least twenty-two (22) feet in width.
- D. All off-street parking areas, **areas over which vehicles will travel, and all areas upon which materials and/or equipment will be stored** shall be surfaced with an all-weather wearing surface of plant mix asphaltic concrete over crushed stone base subject to approval by the City Engineer. A proposal to use other materials shall be submitted to the Plan Commission and the Engineering Department for approval. **Phasing of the parking area shall include the installation of concrete or similar visual barriers to prevent the parking, travel, or storage of materials on or over future phases/expansion areas. Phase one paving of the parking areas, private drives, and storage areas as depicted on plans approved January 14, 2014, shall be in place by July 1, 2014 and prior to the operation of the business.**
- E. Other parking arrangements, showing traffic circulation and dimensions, shall be submitted to the Plan Commission for approval.
- F. All driveway approaches to this property shall be in compliance with all the standards set forth in Chapter 6 of the Oak Creek Municipal Code. Any off-site improvements shall be the responsibility of the property owner.
- G. All off street parking areas shall be landscaped in accordance with Sections 17.0330 & 17.0403 of the Municipal Code.

4. LIGHTING

All plans for new outdoor lighting shall be reviewed and approved by the Electrical Inspector in accordance with Section 17.0808 of the Municipal Code.

5. LANDSCAPING

A. **The site containing this conditional use shall be maintained in accordance with the site, building, and landscaping plans dated May 23, 2008 and approved by the City of Oak Creek Plan Commission on August 10, 2010. All plans for landscaping changes shall be submitted to the Plan Commission for their review and approval.**

B. **Parking Lot Screening.** Those parking areas for five (5) or more vehicles if adjoining a residential zoning district line or public right-of-way shall be screened from casual view by an earth berm, a solid wall, fence, evergreen planting of equivalent visual density or other effective means approved by the City Plan Commission. Such fence or berm and landscaping together shall be an average of three (3) feet in height between the parking and the street right-of-way. All screening materials shall be placed and maintained at a minimum height of three (3) feet.

1. At least one ornamental deciduous tree, no less than 2.5" caliper, shall be incorporated into the design for every 35 linear feet of public street frontage.
2. At least 25% of the total green space area shall be landscaped utilizing plant materials, other than maintained turf, that contribute to ground coverage.
3. For purposes of determining the number of plants necessary to meet the minimum 25% ground coverage requirement, plant types are categorized by their general size and potential mature at-grade coverage area.

<u>Plant Type</u>	<u>Area of Coverage Provided</u>
Evergreen Tree (>8' Dia.)	75 sq. ft.
Large Shrub (6-8' Dia.)	38 sq. ft.
Medium Shrub (4-6' Dia.)	20 sq. ft.
Small Shrub (2-4' Dia.)	12 sq. ft.
Perennial (4.5" Pot)	6 sq. ft.

* Note shade and ornamental trees are not considered a plant type contributing to "at grade" coverage.

4. To assure a diversity of color, texture and year-round interest, the total number of plant materials must be comprised of a minimum 25% evergreens, but no more than 70%.
- C. **Interior Landscape Area.** All public off-street parking lots which serve five (5) vehicles or more shall be provided with accessory landscaped areas; which may be landscape islands, landscape peninsulas or peripheral plantings totaling not less than five (5) percent of the surfaced area. Landscape islands or peninsulas shall be dispersed throughout the off-street parking area. Landscape islands shall provide a minimum 30-inch clear area for vehicle overhang and snow storage. One shade tree shall be provided within the interior planting area for every 300 square feet of interior landscaping.
- D. **Perimeter Landscape Area.** In an effort to prevent adjacent parking lots from becoming one large expanse of paving, perimeter landscaping shall be required. The perimeter strip shall be a minimum 5 feet in width. A minimum of one tree and five shrubs is required for every 35 linear feet of the perimeter of the parking area and located within the perimeter landscape area.
- E. **Landscaping Adjacent to Buildings.** There shall be a minimum three-foot landscaped area provided between the edge of pavement and the entrance elevation of the building.
- F. **Screening of Trash.** Trash receptacles shall not be located within the front or street yard, and shall be screened from casual view by means of screening that is compatible with the main building/structure and landscaping.

- G. Screening of Ground Mounted Mechanical Equipment. Ground mounted mechanical equipment shall not be located within the front or street yard, and shall be screened from casual view by means of screening that is compatible with the main building/structure and landscaping.
- H. Screening of Outdoor Storage – Outdoor storage **shall be located behind the existing fence and on paved areas only (no storage permitted on gravel).**
- I. Screening of Roof Mounted Mechanical Equipment - Roof mounted mechanical equipment shall be screened from casual view.
- J. Retaining Walls. No retaining wall shall exceed four (4) feet in height unless it has been designed and its construction supervised by a Professional Engineer. A retaining wall may be stepped to achieve greater height. Each step of the wall shall be no more than four (4) feet in height and shall be set back a minimum of three (3) feet from the previous step. Acceptable materials for retaining walls are: segmental masonry type, timber, railroad ties, or concrete
- K. Berms. Side slopes of berms shall not exceed a gradient of 1-ft. vertical to 3-ft. horizontal unless approved by the City Engineer.
- L. Buffer Yards. Appropriate buffers shall be provided between dissimilar uses as set forth in Section 17.0205 (d) of the Municipal Code, and in accordance with the plans approved by the Plan Commission on May 23, 2000 and September 24, 2013.
- M. Submittal Requirements. A Landscape Plan (to scale) must be submitted which includes details of all proposed landscaping, buffering and screening, including the estimated cost of the landscaping. These plans shall be prepared by a landscape professional and show the location and dimensions of all existing and proposed structures, parking, drives, right-of-ways and any other permanent features, and all other information required by the Plan Commission, including but not limited to the following:
 - 1. A plant list and coverage chart showing the location, quantity, size (at time of planting and at maturity), spacing and the scientific and common names of all landscape materials used.
 - 2. The location and type of existing trees over four (4) inches in diameter (measured six (6) inches above the ground) within the area to be developed.
 - 3. The location and percent of slope of all proposed berms using one (1) foot contours.
 - 4. Detailed sections showing elevations of all proposed architectural features, such as walls, lighting or water features.
 - 5. Methods used in staking, mulching, wrapping or any other early tree care used.
 - 6. The Plan Commission shall impose time schedules for the completion of buildings, parking areas, open space utilization, and landscaping. The Plan Commission may require appropriate sureties to guarantee that improvements will be completed on schedule.

6. ARCHITECTURAL STANDARDS

- A. **The site and building containing this conditional use shall be constructed and maintained in accordance with the site, building, landscaping and lighting plans dated May 23, 2008 and approved by the City of Oak Creek Plan Commission on August 10, 2010. Any changes to these plans shall be submitted to the Plan Commission for their review and approval.**

- B. No building shall be permitted if the design or exterior appearance is of such unorthodox or abnormal character in relation to its surroundings as to be unsightly or offensive to generally accepted taste and community standards.
- C. No building shall be permitted where any exposed facade is not constructed or faced with a finished material which is aesthetically compatible with the other facades of surrounding properties and presents an attractive appearance to the public. Predominant exterior building materials must be of high quality. These include, but are not limited to brick, stone and tinted/textured concrete masonry units (CMU's). Smooth-faced concrete block, EIFS products (such as Dryvit) or pre-fabricated steel panels are not permitted as a primary exterior building material.
- D. The facade of a manufacturing, commercial, office, institutional, or park building shall be finished with an aesthetically pleasing material. A minimum of seventy-five (75) percent of the visible perimeter (see diagram) shall be finished with glass, brick or decorative masonry material.
- E. Material and color samples shall be submitted to the Plan Commission for review and approval.
- F. The Plan Commission has the discretion to adjust this minimum for building additions.
- G. The relative proportion of a building to its neighboring buildings or to other existing buildings shall be maintained or enhanced when new buildings are built or when existing buildings are remodeled or altered.
- H. Each principal building shall have a clearly defined, highly visible customer entrance with features such as canopies or porticos, arcades, arches, wing walls, and integral planters.
- I. Sides of a building that are visible from adjoining residential properties and/or public streets should contribute to the pleasing scale features of the building by featuring characteristics similar to the front façade of the building.
- J. Dumpsters and other trash receptacles shall be fenced and/or screened from view from street rights-of-way and adjacent residential uses.
- K. The Plan Commission shall impose time schedules for the completion of buildings, parking areas, open space utilization, and landscaping. The Plan Commission may require appropriate sureties to guarantee that improvements will be completed on schedule; as well as the approved protection of the identified wetlands and woodlands on the approved plan.

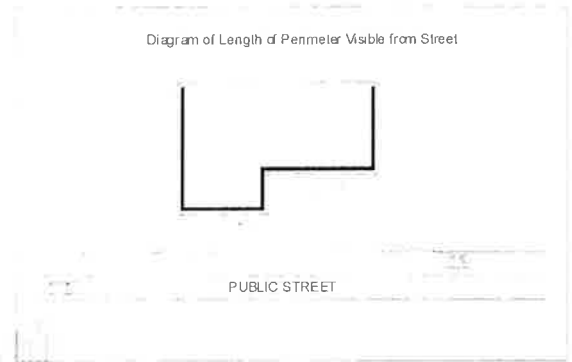

7. BUILDING AND PARKING SETBACKS

	Front and Street Setback	Rear Setback	Side Setback
Principal Structure	40'	20'	20'
Accessory Structure*	40'	20'	20'
Off-street Parking	40'	0'	0'

* No accessory structures shall be permitted in the front yard.

8. MAINTENANCE AND OPERATION

- A. The number, size, location and screening of appropriate solid waste collection units shall be subject to approval of the Plan Commission as part of the required site plan. Solid waste collection and recycling shall be the responsibility of the owner.
- B. Removal of snow from off-street parking areas, walks and access drives shall be the responsibility of the owners.
- C. **Outdoor storage shall be limited in accordance with Section 5(H). A detailed plan for the storage areas shall be submitted to the Plan Commission for review and approval.**

9. SIGNS

All signs shall conform to the provisions of Sec. 17.0706 of the Municipal Code. All signs must be approved by the Plan Commission as part of the site plan review process.

10. PERMITTED USES

- A. All permitted uses in the M-1, Manufacturing (PUD) zoning district.
- B. **One (1) environmental contractor's yard with outdoor storage within the existing fenced area.**
- C. Usual and customary accessory uses to the above listed permitted uses.

11. TIME OF COMPLIANCE

The operator of the conditional use shall commence operations in accordance with these conditions and restrictions for the conditional use within twelve (12) months from the date of adoption of the ordinance authorizing the issuance of a conditional use permit. This conditional use approval shall expire within twelve (12) months after the date of adoption of the ordinance if an occupancy permit has not been issued for this use. The applicant shall re-apply for a conditional use approval, prior to recommencing work or construction.

12. OTHER REGULATIONS

Compliance with all other applicable City, State, DNR and Federal regulations, laws, ordinances, and orders not heretofore stated or referenced, is mandatory.

13. VIOLATIONS & PENALTIES

Any violations of the terms of this conditional use permit shall be subject to enforcement and the issuance of citations in accordance with Section 1.20 of the City of Oak Creek Code of Ordinances. If the owner, applicant or operator of the conditional use permit is convicted of two or more violations of these conditions and restrictions or any other municipal ordinances within any 12 month period the city shall have the right to revoke this conditional use permit, subject to the provisions of paragraph 14 herein. Nothing herein shall preclude the City from commencing an action in Milwaukee County Circuit Court to enforce the terms of this conditional use permit or to seek an injunction regarding any violation of this conditional use permit or any other city ordinances.

14. REVOCATION

Should an applicant, his heirs, successors or assigns, fail to comply with the conditions and restrictions of the approval issued by the Common Council, the Conditional Use approval may be revoked. The process

for revoking an approval shall generally follow the procedures for approving a Conditional Use as set forth in Section 17.1007 of the Municipal Code.

15. ACKNOWLEDGEMENT

The approval and execution of these conditions and restrictions shall confirm acceptance of the terms and conditions hereof by the owner, and these conditions and restrictions shall run with the property unless revoked by the City, or terminated by mutual agreement of the City and the owner, and their subsidiaries, related entities, successors and assigns.

Owner's authorized representative

Date

(please print name)

Location Map

9730 S. 20th St.

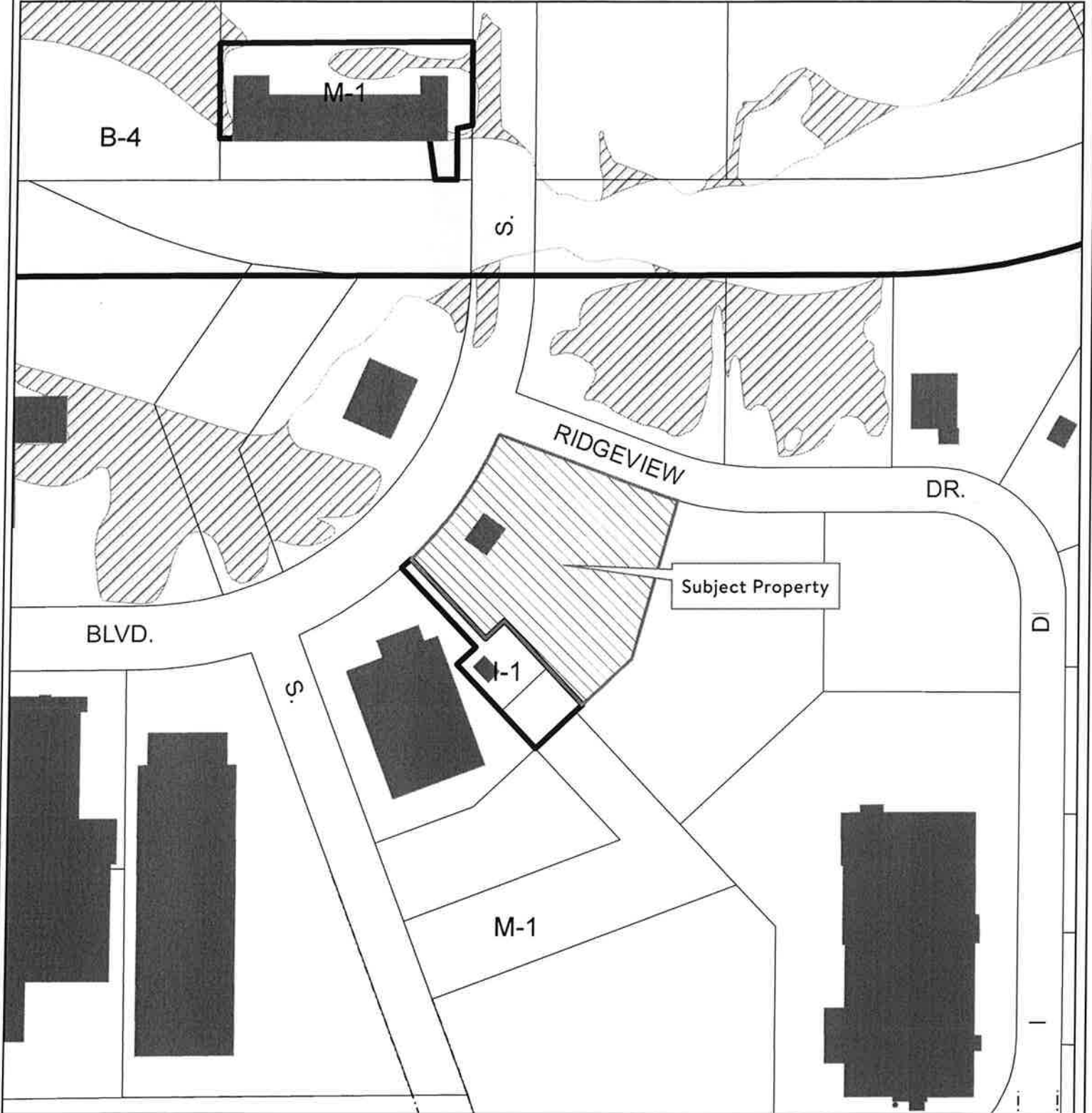

OAKCREEK
— WISCONSIN —

Department of Community Development



Legend	
	9730 S. 20th St.
	Existing Street Pattern
	Floodfringe
	Wetland
	Floodway

RESOLUTION OF APPRECIATION
TO
SANDRA K. DEFORD

WHEREAS, SANDRA K. DEFORD began her service with the City of Oak Creek on December 1, 1993, providing part time assistance to the offices of the City Clerk and the Contract Assessor. In 1997, she became certified as an Assessment Technician through the Department of Revenue and in 1999, became a full time state certified Assessment Technician for the City of Oak Creek and maintained certification, thereafter; and

WHEREAS, in 2002, SANDRA K. DEFORD assumed various assessing duties when the Assistant Assessor retired; and

WHEREAS, SANDRA K. DEFORD held the position of Assessment Technician until October 31, 2013; and as an Administrative Support Assistant until January 17, 2014; where she assisted with record retention and cross trained in the Treasurer's office; and

WHEREAS, SANDRA K. DEFORD provided valuable services to the City Clerk for 17 years and 5 months, where she assisted with several City elections and served on the Board of Canvass; and to the City Treasurer for 2 years and 8 months where she oversaw daily management of the Assessor's office and apprised the City Clerk and City Treasurer of various matters affecting that office; and

WHEREAS, SANDRA K. DEFORD received Board of Review certification training and assisted at several Board of Review sessions; and

WHEREAS, SANDRA K. DEFORD assisted the Contract Assessor in closing the annual assessment rolls for 20 years and assisted with five revaluations, including the reconciliation of the Department of Revenue's manufacturing real estate and personal property assessment rolls with the local assessment rolls; and

WHEREAS, SANDRA K. DEFORD served as a liaison with the Department of Revenue and the Milwaukee County Register of Deeds in resolving various issues; and

WHEREAS, SANDRA K. DEFORD worked closely with the Manufactured Housing Community resolving concerns and assisting with monthly and annual reports; and

WHEREAS, SANDRA K. DEFORD has achieved various certifications through the Federal Emergency Management Institute successfully completing various Incident Command System and National Incident Management System courses; reaffirming her dedication to serve in a time of crisis; and

WHEREAS, SANDRA K. DEFORD participated in two Emergency Operation Incidents: a train derailment and a liquid nitrogen gas explosion that occurred in the City of Oak Creek; assisting city leaders and the community during these emergencies; and

WHEREAS, SANDRA K. DEFORD performed her duties commendably; professionally assisting all who contacted the City of Oak Creek; and

WHEREAS, SANDRA K. DEFORD, retired from the City of Oak Creek on January 17, 2014, after twenty years, one month and seventeen days of dedicated service to the City of Oak Creek.

NOW, THEREFORE, BE IT RESOLVED by the Mayor and Common Council of the City of Oak Creek, for and on behalf of the citizens of the City of Oak Creek, that sincere gratitude and appreciation be extended to Sandra K. DeFord for her years of professional, dedicated and faithful service to the City of Oak Creek and that the best wishes for good health and happiness be extended to Sandra K. DeFord and her family for future years.

BE IT FURTHER RESOLVED that this resolution be spread upon the minutes of this meeting and that the City Clerk is hereby directed to transmit a suitable copy thereof to Sandra K. DeFord.

Presented and adopted this 21st day of January, 2014.

President, Common Council

Approved this 21st day of January, 2014.

Mayor, City of Oak Creek

ATTEST:

City Clerk

Vote: Ayes _____ Noes _____

City of Oak Creek Common Council Report

Meeting Date: 1/21/14

Item No.: 8

Recommendation: That the Common Council approve license agreements with SESAC (Society of European Stage Authors and Composers), BMI (Broadcast Music Inc.), and ASCAP for the re-broadcast of music by licensed performers.

Background: There are three music copyright protection/licensing companies - ASCAP, BMI and SESAC. The artists receive royalties when their work is used, including music in the park, replaying radio music over the phone system, etc. It is recommended that these annual payments be approved.

Fiscal Impact: The fees that are due pursuant to the agreement are based on population. In this instance, Oak Creek falls in the 1-50,000 population category for BMI for a 2013 fee of \$297; SESAC - 25,001-50,000 for a fee of \$685. and ASCAP - 1-50,000 for a fee of \$330.

Payment will be taken from Account 40-420 General Government Dues and Publications.

Prepared by:



Christa J. Miller, WCMC
Deputy City Clerk

Respectfully submitted by:



Gerald R. Peterson, ICMA-CM
City Administrator

Approved by:

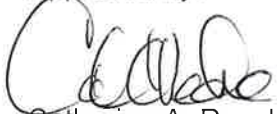

Catherine A. Roeske
City Clerk

Fiscal Reviewed by:



Bridget M. Souffrant, CMTW
Finance Director / Comptroller



Invoice & Remittance Advice	
Account Number:	1894386
Billing Number:	24445227
Billing Date:	02-JAN-2014
Total Amount Due:	USD 297.00
Amount Enclosed:	

Pay Online: www.bmi.com/payments

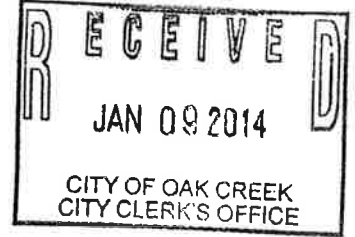

City Clerk
 Oak Creek, Wisconsin
 8640 S Howell Ave
 P O Box 27
 Oak Creek WI 53154

1894386244452270000002970016

BMI
 PO Box 630893
 Cincinnati OH 45263-0893

Contact us: (888) 492-6264
www.bmi.com/email

Please return the above portion with your payment
 Correspondence written on this notice or sent to this address will not be recognized by BMI

Billing Number	Beginning Balance	Billed and Adjusted	Payments	Ending Balance
24445227	\$0.00	\$297.00	\$0.00	\$297.00

Date	Type	Transaction #	Description	Amount Due (in USD)
Account# 1894386 Oak Creek, Wisconsin 8640 S Howell Ave P O Box 27 Oak Creek WI 53154				
01-JAN-2014	INV	8271744	Estimated Fee 01/01/2014 - 12/31/2014	\$297.00

If you are billed quarterly or semi-annually and your payment is 90 days past due, the unpaid balance of your Annual Fee is now due in full.

BMI customers have the following online features:

Manage your account online using the account and billing numbers appearing on the top of this invoice at: www.bmi.com/lge. Make a payment at: www.bmi.com/payments. In addition to American Express, MasterCard, Discover and VISA, we now accept payments from BOTH business and personal checking accounts.

Recently held a Special Event with gross revenues in excess of \$25,000 or more? These events should be reported within 90 days as outlined in your BMI Local Government Entities License agreement. Please contact your BMI representative at 877-264-2137 to request a report form.

Connect with additional savings for your business at: www.bmi.com/jbl - www.bmi.com/dell - www.bmi.com/fedex.

MUSIC LICENSE ACCOUNT INVOICE

RETAIN THIS
PORTION FOR
YOUR RECORDS.



55 MUSIC SQUARE EAST
NASHVILLE, TN 37203-4362
1-615-320-0055

Acct # 63-48-01019 ID# 240838
City of Oak Creek
INVOICE
ACCOUNT BILLED: ANNUALLY
Date printed: 12-13-13

SESAC FED. I.D. NO.: 13-1325220

REF. NO.	TRANS. DATE	CURRENT CHARGES	PAYMENTS/ADJUSTMENTS	SUB-TOTAL	CODE
3784766	1-01-14	685.00		685.00	IV

The 1-01-14 invoice amount noted above represents License fees for the period of 1-01-14 thru 12-31-14.

AJ - ADJUSTMENT CM - CREDIT MEMO DS - DISCOUNT	IV - INVOICE LC - LATE CHARGE PY - PAYMENT	TX - TAX	TOTAL DUE ▶	\$685.00
--	--	----------	--------------------	-----------------

In accordance with your SESAC license, your 2014 annual fee is \$685.00.

Mail correspondence to: SESAC Inc., 55 Music Square East, Nashville, TN 37203

**PAYMENTS RECEIVED AFTER THE 15TH OF THE MONTH DO NOT APPEAR ON THIS INVOICE
PAYMENTS ARE POSTED TO THE OLDEST OUTSTANDING CHARGES**

Three ways to pay! Return this stub with your 1) check or 2) credit card information; or 3) pay online at www.sesac.com/asp/dLicPay.asp

To avoid late charges, please pay the total due by the due date.

DATE DUE **01-01-14** TOTAL DUE **\$685.00**

If paying by check:

CHECK NO.: _____ AMOUNT PAID \$ _____

FOR INTERNAL USE ONLY

Loc: **Oak Creek WI**
Acct: **63-48-01019** Fac: **240838**
CnCd: **IB**

If paying by VISA or MasterCard:

Amount Charged \$ _____

Cardholder Name _____

Card Billing Address _____

City _____ State _____ Zip: _____

Card #: _____

Expiration Date: ____/____/____ Security Code (see reverse*) _____

SIGNATURE: _____

CITY OF OAK CREEK
C/O CITY HALL
8640 S HOWELL AVE
OAK CREEK WI 53154-2918

SESAC
P.O. BOX 900013
Raleigh, NC 27675-9013

28127



63480101902408380000068500

Please send all correspondence to 55 Music Square East, Nashville, TN 37203



PO BOX 331608-7515
Nashville, TN 37203-9998
Attn: Account Services
Phone: 1-800-505-4052
Fax: 1-615-691-7795

A S C A P

December 20, 2013

G36ZRX001002903 -

Christa Miller
Mayor
City Of Oak Creek
City Of Oak Creek
8640 S Howell Ave
Oak Creek, WI 53154-2918

Re: Account No. - 500601424
City Of Oak Creek
City Of Oak Creek
8640 S Howell Ave
Oak Creek, WI 53154-2918

Dear Mr. Miller:

Your 2014 ASCAP Rate Schedule is attached. Based on the Consumer Price Index, All Urban Consumers - (CPI-U) between October 2012 and October 2013, the 2014 Rate Schedule increased by 0.96361% over the 2013 Rate Schedule. We recommend that you attach the Rate Schedule to your License Agreement for future reference.

In accordance with the terms of the Agreement, Base Licensee Fees are due and payable within 30 days of the renewal date, and shall be accompanied by a statement confirming whether any Special Events were presented during the previous calendar year. Please complete and return the enclosed report form, along with your payment within 30 days of the renewal date of your License Agreement, which is 05/31/2014. You may also copy this form to report any Special Events you have during the year.

Should you prefer to make a payment via Electronic Check or Credit Card, and/or view your account balance and payment history, you may visit us at our secure ASCAP website: www.ASCAP.com/mylicense. Your account information is encrypted for maximum security. It is our strict policy not to make any individual customer data available to third parties for any reason. You may continue to send your report form by mail, via fax (1-615-691-7795) or to us via email at glcs@ascap.com.

We at ASCAP are proud to serve your licensing needs and would like to take this opportunity to extend our best wishes to you for a successful new year.

Sincerely,

Account Services

Account Services

Enclosures:
Rate Schedule
Report Form
Return Envelope

F0166_0114
IMLA

 ASCAP	LOCAL GOVERNMENT ENTITIES 2014 Rate Schedule and Report Form
Account No.: 500601424	Premise Name: City Of Oak Creek; Oak Creek, WI
Report Due: 12/30/2014	



SCHEDULE A: Base License Fee

Population Size			Base License Fee
1	to	50,000	\$330.00
50,001	to	75,000	\$657.00
75,001	to	100,000	\$791.00
100,001	to	125,000	\$1,053.00
125,001	to	150,000	\$1,317.00
150,001	to	200,000	\$1,712.00
200,001	to	250,000	\$2,106.00
250,001	to	300,000	\$2,502.00
300,001	to	350,000	\$2,898.00
350,001	to	400,000	\$3,292.00
400,001	to	450,000	\$3,686.00
450,001	to	500,000	\$4,083.00
500,001	Plus***		\$5,003.00

*** \$5,003.00 plus \$500 for each 100,000 of population above 500,000 to a maximum fee of **\$65,833.00**

SCHEDULE B: Special Events

The rate for Special Events shall be 1% of Gross Revenue.

"Special Events" means musical events, concerts, shows, pageants, sporting events, festivals, competitions, and other events of limited duration presented by LICENSEE for which the "Gross Revenue" of such Special Event exceeds \$25,000.

"Gross Revenue" means all monies received by LICENSEE or on LICENSEE'S behalf from the sale of tickets for each Special Event. If there are no monies from the sale of tickets, "Gross Revenue" shall mean contributions from sponsors or other payments received by LICENSEE for each Special Event.

SCHEDULE C: State Municipal and/or County Leagues or State Associations of Attorneys

The annual license fee for LICENSEES who are legally organized as state municipal and/or county leagues or state associations of municipal and/or county attorneys shall be \$330.00

License Fee for Year 2015 and Thereafter

For each calendar year commencing 2015, all dollar figures set forth in Schedules A, B and C above (except for \$500.00 add-on for populations of 500,001 or more) shall be the license fee for the preceding calendar year, adjusted in accordance with the increase in the Consumer Price Index - All Urban Consumers (CPI-U) between the preceding October and the next preceding October. Any additional license fees due resulting from the CPI adjustment shall be payable upon billing by ASCAP.

	LOCAL GOVERNMENT ENTITIES 2014 Rate Schedule and Report Form
Account No.: 500601424	Premise Name: City Of Oak Creek; Oak Creek, WI
Report Due: 12/30/2014	



SCHEDULE A: Base License Fee (Due upon execution of Agreement and within 30 days of the Agreement's Renewal Date.)

Population Size: ---- 34695 (Per current U.S. Census Data) Base License Fee: \$330.00 (Please refer to attached Rate Schedule)

SCHEDULE B: Special Events* (Report and Payment due 90 days after the conclusion of each Special Event)

Event Date (mm/dd/yyyy) If More than 1 Event Per Day, Please Report As Separate Entries)	Performer(s) or Group(s) Appearing	Gross Revenue of Event (Must Exceed \$25,000)	% Applies to Gross Revenue	Event Fee	Is a Program of Musical Works Attached? (Yes/No)	If the Event is Co-Sponsored (Please Identify The Co-sponsor's Name, Address, Phone Number and ASCAP Account Number)
n/a			x .01	\$		Name: _____ Address: _____ Phone No: _____ Account No: _____
			x .01	\$		Name: _____ Address: _____ Phone No: _____ Account No: _____
			x .01	\$		Name: _____ Address: _____ Phone No: _____ Account No: _____
			x .01	\$		Name: _____ Address: _____ Phone No: _____ Account No: _____

****Special Events**** means musical events, concerts, shows, pageants, sporting events, festivals, competitions, and other events of limited duration presented by LICENSEE for which the "Gross Revenue" of such Special Event exceeds \$25,000.

*****Gross Revenue**** means all monies received by LICENSEE or on LICENSEE'S behalf from the sale of tickets for each Special Event. If there are no monies from the sale of tickets, "Gross Revenue" shall mean contributions from sponsors or other payments received by LICENSEE for each Special Event.

ASCAP, P. O. Box 331608-7515, Nashville, TN 37203-9998 1-800-505-4052 1-615-691-7795 (FAX)
 Epayment Websites: <http://www.ascap.com/mylicense> or <http://www.ascap.com>

City of Oak Creek Common Council Report

Meeting Date: January 21, 2014

Item No.: 9

Recommendation: That the Common Council approves payment of the obligations as listed on the January 15, 2014 - 2013 & 2014 Vendor Summary Report.

Background: Of note are the following payments:

1. \$55,337.00 to Bray Associates Architects Inc (pg #3) for architectural services city hall/library and fire station.
2. \$6,515.00 to Buelow Vetter Buikema Olson (pg #3) for December legal services.
3. \$21,330.00 to Godfrey & Kahn S.C. (pg #7) for October legal services regarding 220 acre lakefront redevelopment.
4. \$21,240.00 to Graef (pg #7) for BEBR & SAG/DTS administrative services.
5. \$34,850.00 to John's Disposal Service, Inc. (pg #9) for December disposal service.
6. \$50,216.69 to JPMorgan Chase Bank NA (pgs #9-14) for office supplies, grounds/building maintenance, computer hardware/software, November Verizon charges, books, audio visual/photo supplies, legal notices, ERU equipment and travel/training.
7. \$9,465.71 to Mayer Repair LLC (pg #15) for fire department vehicle repair.
8. \$22,486.98 to SmithgroupJJR (pg #19) for grant services.
9. \$17,650.00 to Tyler Technologies, Inc. (pg #21) per assessor contract.
10. \$6,344.00 to Denise A. Vandebush, CPA (pg #21) for finance department special projects.
11. \$35,661.43 to WE Energies (pg #22) for street lighting and warning sirens.
12. \$25,102.94 to World Fuel Services, Inc. (pg #22) for fuel inventory.
13. \$5,700.00 to Bay View Advanced Management (pg #2) for mandatory community health improvement planning process and facilitation.
14. \$5,412.84 to Demco, Inc. (pg #3) for 2014 magazine subscriptions.
15. \$8,050.00 to GCS Software, Inc. (pg #5) for software annual license fee.
16. \$89,520.53 to Holz Motors, Inc. (pg #7) for police vehicles.
17. \$6,388.97 to Gordon P & Barbara A Jakus (pg #7) for tax overpayment refund.
18. \$6,411.30 to Minnesota Life Insurance Co (pgs #10-11) for group life insurance.
19. \$9,987.94 to National Insurance Company (pg #12) for disability insurance.
20. \$48,301.25 to ProPhoenix (pg #13) for annual maintenance and support.
21. \$5,000.00 to Reserve Account (pg #14) to refill postage machine.
22. \$5,004.00 to Vermont Systems, Inc. (pg #15) for Rectrac software support.
23. \$5,248.34 to Wells Fargo Real Est Tax Svc (pg #16) for tax overpayment refunds.
24. \$25,651.62 to World Fuel Services (pg #17) for fuel inventory.
25. \$5,000.00 to Silver Circle LLC (pg #26) for tax overpayment refund.

Fiscal Impact: Total claims paid of \$391,575.24 for 2013 and \$316,471.34 for 2014. Total of all claims \$708,046.58.

Prepared by/Fiscal Review by:

Respectfully submitted,



Bridget M. Souffrant, CMTW
Finance Director/Comptroller

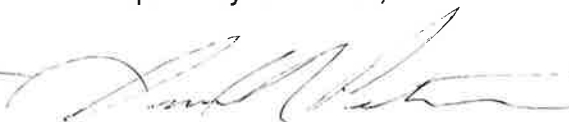

Gerald R. Peterson, ICMA-CM
City Administrator

City of Oak Creek Common Council Report

Meeting Date: January 21, 2014

Item No.: 10

Recommendation: That the Common council adopt Resolution No. 11450-012114, acknowledging and filing the 2014 calendar year salary grade plan and benefits for library personnel.

Background: Annually, the Oak Creek Public Library Board sets salary increases for their employees.

Fiscal Impact: Allocation has been made in the 2014 library budget.

Prepared by:



Jill Lininger
Library Director

Respectfully submitted,



Gerald R. Peterson, ICMA-CM
City Administrator

Fiscal Review by:

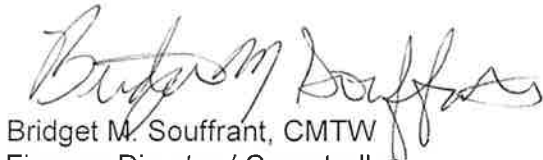

Bridget M. Souffrant, CMTW
Finance Director / Comptroller

RESOLUTION NO. 11450-012114

RESOLUTION ACKNOWLEDGING AND FILING THE
2014 CALENDAR YEAR SALARY GRADE PLAN AND
BENEFITS FOR LIBRARY PERSONNEL

WHEREAS, pursuant to S. 43.58(4), Wisconsin Statutes, the Library Board is authorized and empowered to set and fix the compensation to be paid to the personnel of the Public Library; and

WHEREAS, those affected full-time employees pursuant to this section shall receive the fringe benefits set forth in the current Personnel Manual; and

WHEREAS, the Library Board, in addressing retiree benefits for full-time employees who are eligible for retirement, has authorized those eligible full-time employees to receive the benefits set forth in the current Personnel Manual; and

WHEREAS, a health insurance premium co-payment of fifteen percent (15%) of the cost of the health insurance premium for a single and family medical plan, respectively will be paid by full-time Library employees. Full-time Library employees and their spouses who participate in a health risk assessment (HRA) program, or an annual physical exam and completion of the HRA certification, shall contribute ten percent (10%) of the premium for a single and family plan, respectively; and

WHEREAS, the Library Board has also transmitted to the Common Council a salary grade plan for Library Personnel effective January 1, 2014, which provides as follows:

LIBRARY

	<u>2014 Salary Ranges</u>	<u>2013 Salary</u>	<u>2014 Salary</u>
Library Director	\$68,000 - \$76,000	\$71,440	\$ 71,440
Assistant Library Director	\$51,795 - \$57,550	\$53,144	\$53,144
Children's Librarian	\$45,378 - \$50,420	\$50,420	\$50,420
Technology / Reference Librarian	\$45,378 - \$50,420	\$50,420	\$45,378
Young Adult Librarian	\$45,378 - \$50,420	\$46,386	\$46,386
Library Services Assistant	\$41,877 - \$46,530	\$46,530	\$46,530
Library Aides	\$12.30 - \$13.88		
Library Pages	\$7.79 - \$9.37		
Library Intern	\$16.00		

WHEREAS, Library personnel shall be paid for auto expense at the rate allowed under current I.R.S. regulation per the Travel Policy or shall be assigned City vehicles for their usage. In order to qualify for the above mentioned auto mileage reimbursement, the officials and employees designated must provide proof of insurance by a reasonable

insurance company for bodily injury and property damage liability within minimum policy limits of \$250,000/\$250,000/\$25,000. In order to receive mileage reimbursement a Declaration of Coverage page stating the policy limits shall be provided annually by January 31 to the Personnel Office.

NOW, THEREFORE, BE IT RESOLVED by the Mayor and Common Council of the City of Oak Creek that the Salary Grade Plan as hereinabove set forth be and the same is hereby acknowledged and filed.

BE IT FURTHER RESOLVED that the City Clerk be hereby authorized and directed to publish this resolution in the official newspaper as a Class 1 publication for public informational purposes.

This ordinance shall take effect and be in force upon its acknowledgement and publication and shall apply as of January 1, 2014.

Passed and adopted this 21st day of January, 2014.

President, Common Council

Approved this 21st day of January, 2014

Mayor

ATTEST:

City Clerk

VOTE: Ayes _____ Noes _____

City of Oak Creek Common Council Report

Meeting Date: January 21, 2014

Item No.: 11

Recommendation: The Common Council approves the purchase of one Stryker Power-Pro XT cot from Stryker Medical in the amount of \$15,518.

Background: The Oak Creek Fire Department currently maintains five Power-Pro cots. The age and usage of our cots is as follows:

Cot #	Age of Cot	Usage Hours
1	5 yrs	8
2	7 yrs	16
3	8 yrs	13
4	8 yrs	16
5	8 yrs	18

The manufacturer of our cots, Stryker Medical, has identified an age of 7 years and 16 hours of use as the upper limits of normal service life. We currently have three cots that exceed this range.

Each of our cots is subject to preventative maintenance through a certified vendor. This program has allowed us to provide a safe and reliable service to our patients as well as extend the useful life of our equipment. Our vendor does inspect and repair each of our cots, but only certifies those less than 7 years in age. Additionally, as our cots age, repair costs increase. Over the last 3 years, approximately \$10,000 has been spent on preventative maintenance and repairs for our cots.

The addition of a new Power-Pro cot would allow us to rotate Cot #5 out of frontline service. Additionally, repair costs would decrease due to the addition of a new cot and the associated 2 year warranty.

Fiscal Impact: All funds for this purchase will come from the State of Wisconsin Act 102 Emergency Medical Services Funding Assistance Program. This account currently has a balance of \$61,957. The purchase of this cot is identified by the State of Wisconsin as an acceptable use for funds from this account.

Prepared by:

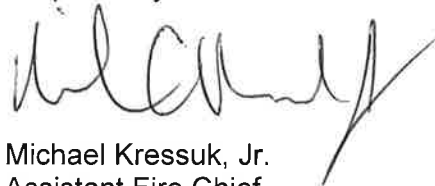

Michael Kressuk, Jr.
Assistant Fire Chief

Respectfully submitted by:



Gerald R. Peterson, ICMA-CM
City Administrator

Fiscal Reviewed by:

A handwritten signature in black ink, appearing to read "Bridget M. Souffrant". The signature is written in a cursive style with a large initial "B".

Bridget M. Souffrant, CMTW
Finance Director / Comptroller